

CYCLEPATH CONSTRUCTION WITH TIMBER EDGING
SCALE 1:20

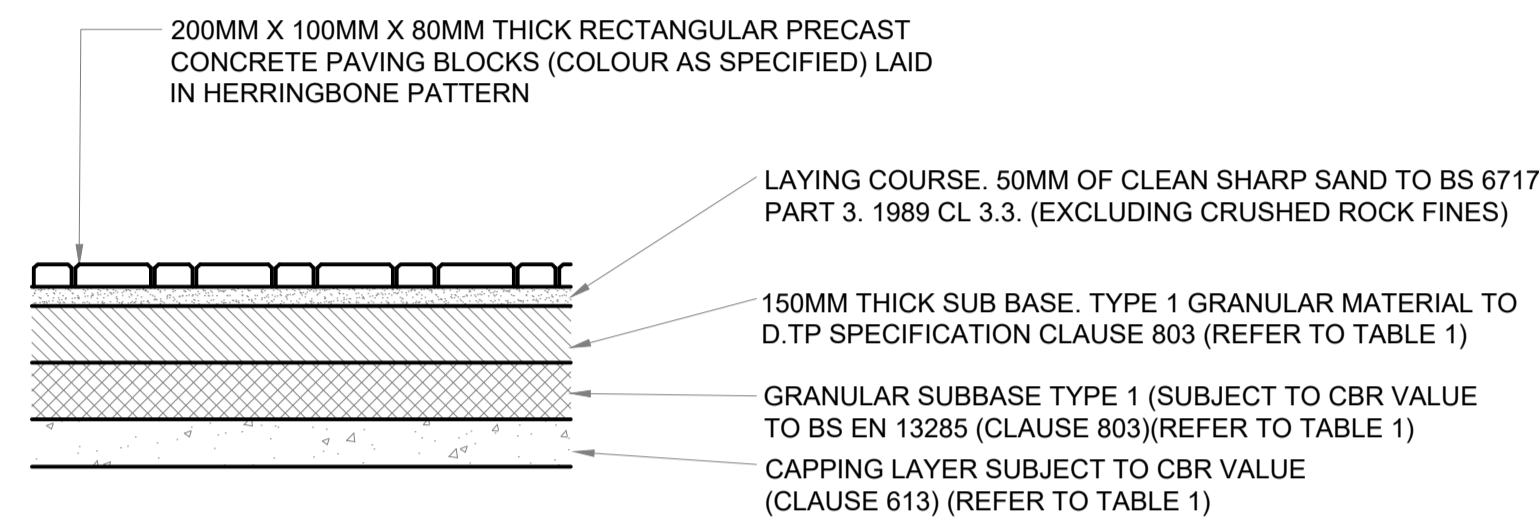

BLOCK PAVED ROAD (SERVICE CORRIDOR)
Scale 1:20

Table 1

CBR value	Subbase	Capping layer
[%]	[mm]	[mm]
5>	250	-
2<CBR<5	150	350
<2	150	600

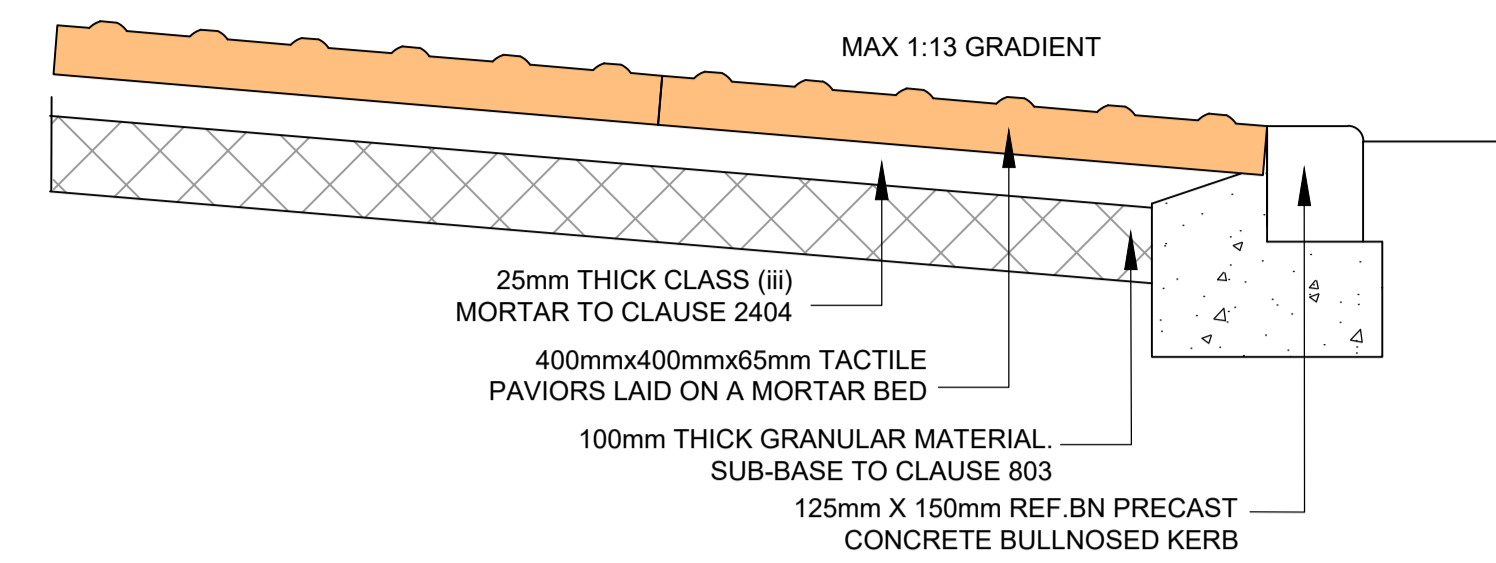

(SECTION A-A)

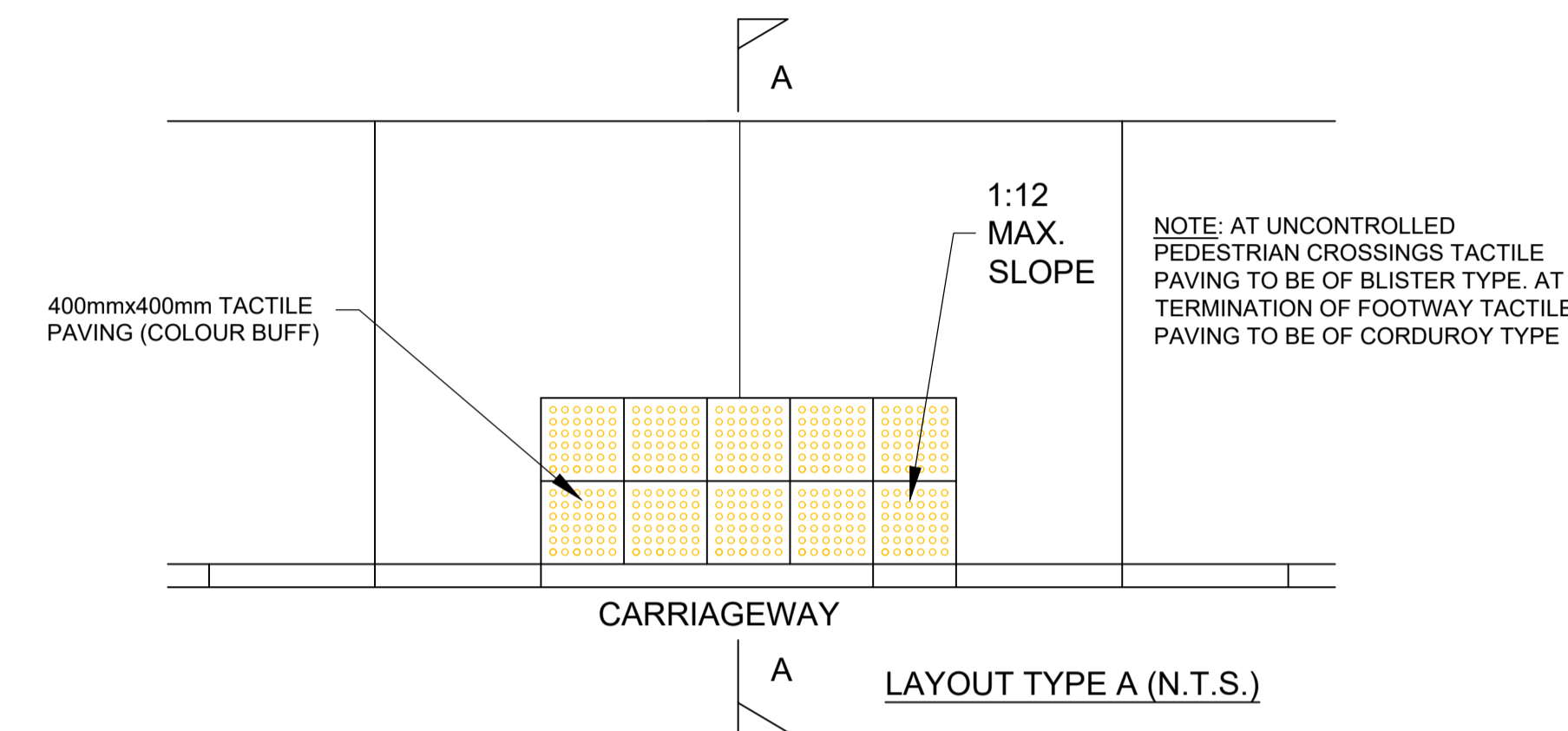

CARRIAGEWAY

LAYOUT TYPE A (N.T.S.)

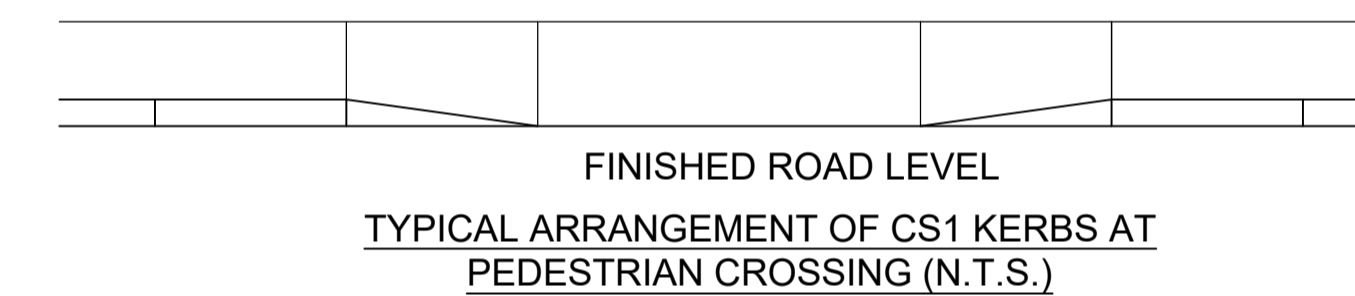

FINISHED ROAD LEVEL
TYPICAL ARRANGEMENT OF CS1 KERBS AT PEDESTRIAN CROSSING (N.T.S.)

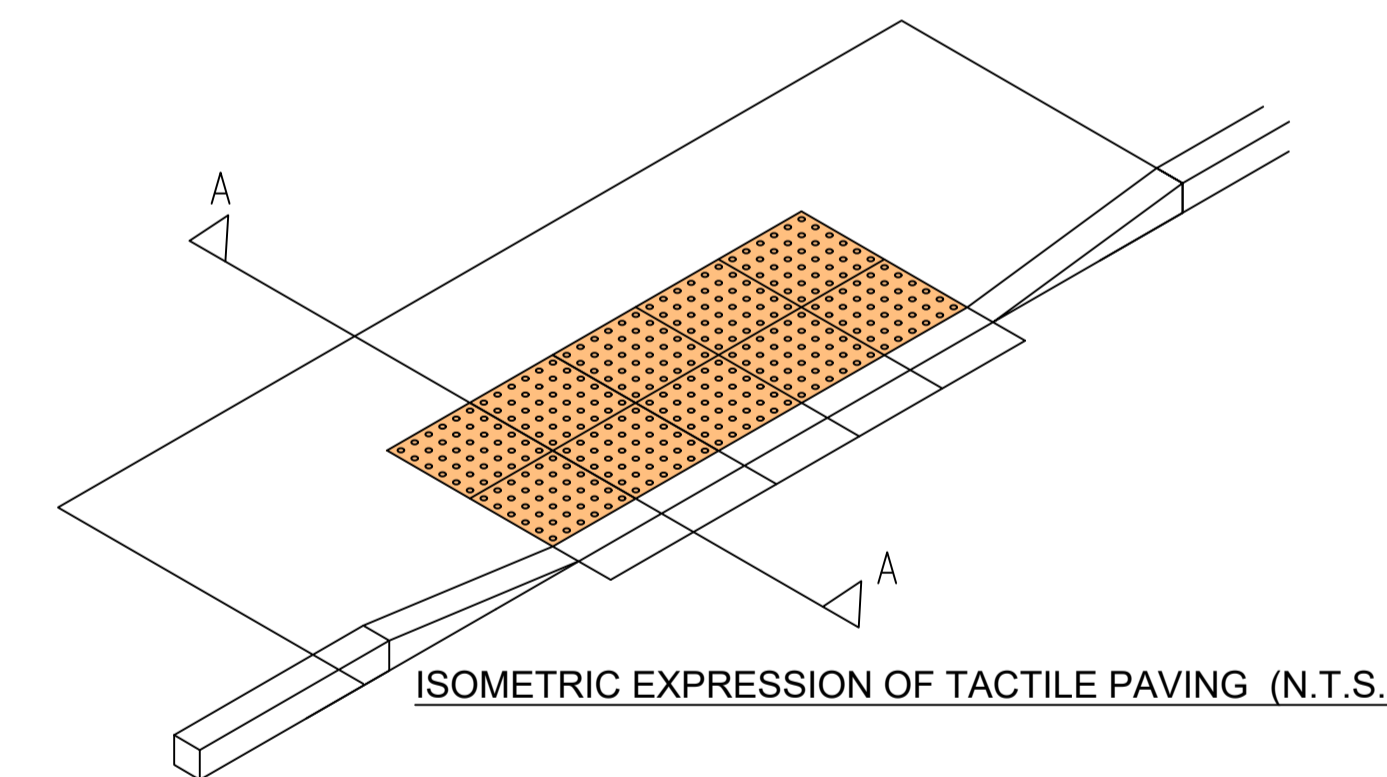

ISOMETRIC EXPRESSION OF TACTILE PAVING (N.T.S.)

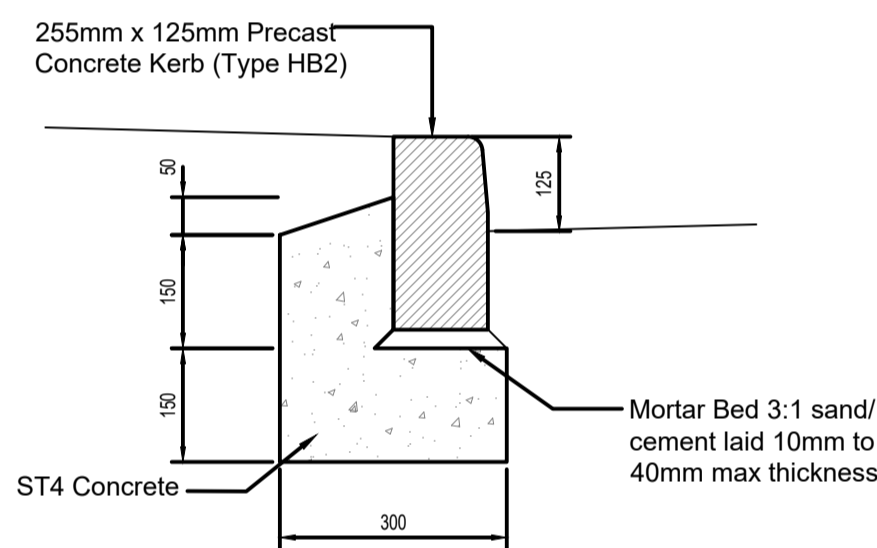

HALF BATTERED KERB (HB2)
(1:10)

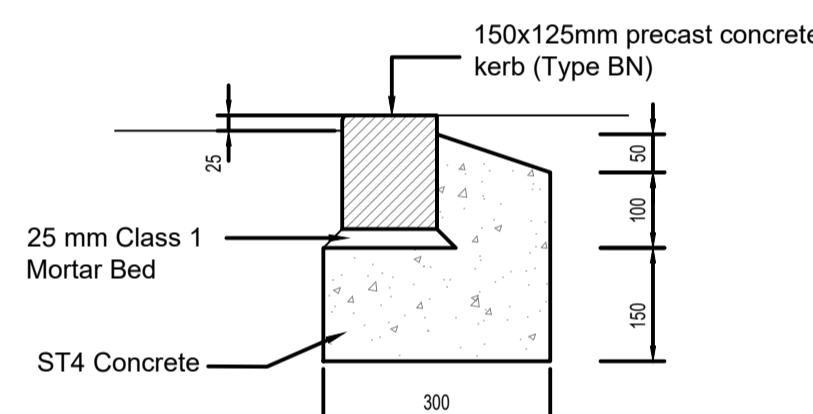

BULLNOSED KERB (BN)
(1:10)

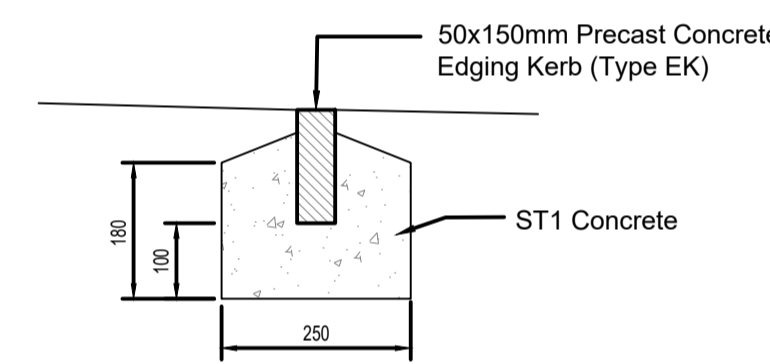

EDGING KERBS (EK)
(1:10)

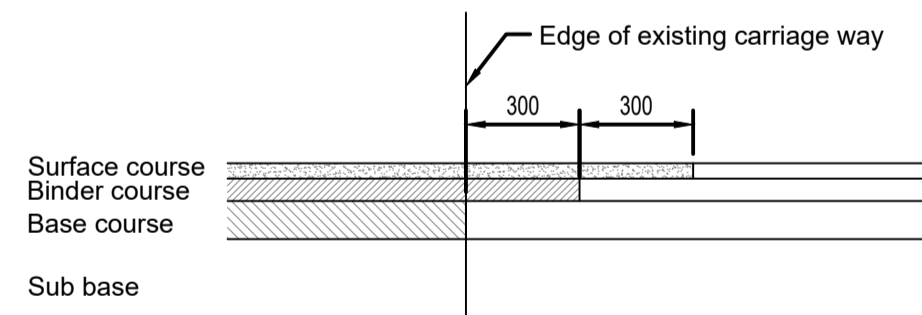

TYPICAL TIE IN DETAIL
(1:20)

- NOTES**
- When coated macadam is laid as base and is not covered immediately with the binder course or binder course is laid and not immediately covered with surface course, then apply coated grit to BS4987 Part 1 to seal the surface.
 - The minimum overall construction thickness of carriageway shall be 450 mm.

P1	FIRST ISSUE FOR COMMENT	RD	EH	TH
Rev.	Description	By	Chk	App



Client:
Abergavenny
3-19 SCHOOL

Project:
EXTERNAL WORKS DETAILS

Drawing No.:
CB2252 CAM XX ZZ DE C 0121

Status: SS PRELIMINARY
Scale @A1: AS SHOWN
Rev: P1

CAMBRIA
Constructive Thinking

Civil & Structural Engineers
Ground Floor,
Building 350,
Bristol Business Park,
Bristol, BS16 1EJ
T 0117 911 3333
E admin@cambria.co.uk
W www.cambria.co.uk
@cambriauk
uk.linkedin.com/in/cambria